

A
PRELIMINARY FLOOR PLAN
10/10/17

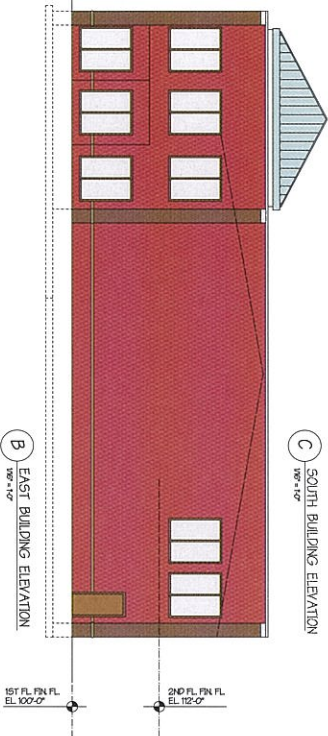

B
EAST BUILDING ELEVATION
10/10/17

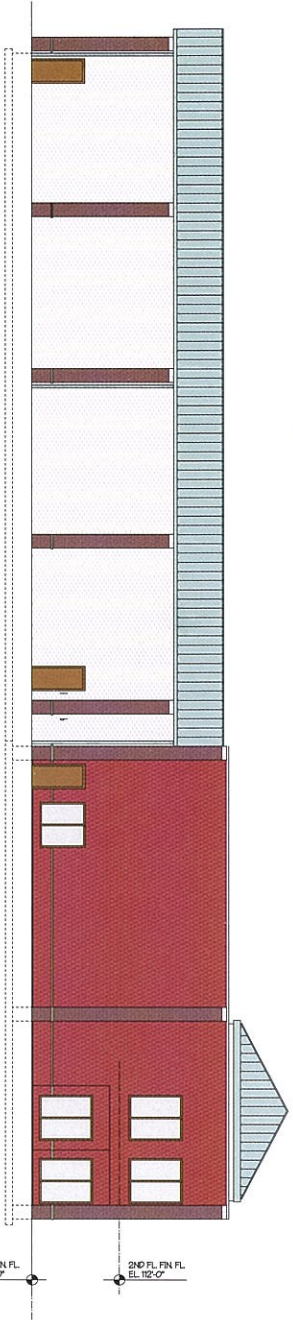

C
SOUTH BUILDING ELEVATION
10/10/17

DATE	04-10-17
CHANG	04-17
REVISION	



 JOHN A. EBERTS
 ARCHITECT
 980 RES. 10409 JVA
 3662 KARL ROAD
 COLUMBUS, OHIO 43224

PHONE 614-262-3601
 FAX 614-262-3602
 jeberts@jwaynet.net

PRELIMINARY AUXILIARY GYMNASIUM STUDY
 TO
 BISHOP HARTLEY HIGH SCHOOL
 1285 ZETTLER ROAD
 COLUMBUS, OHIO 43227

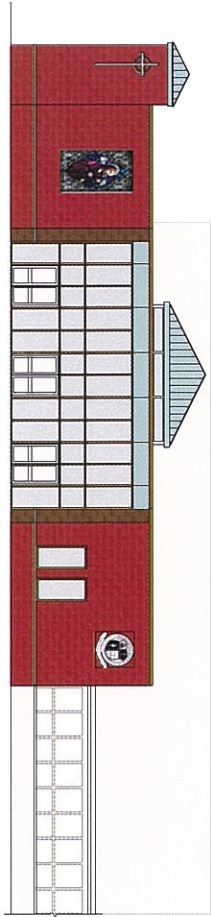

B EAST BUILDING ELEVATION
1/8" = 1'-0"

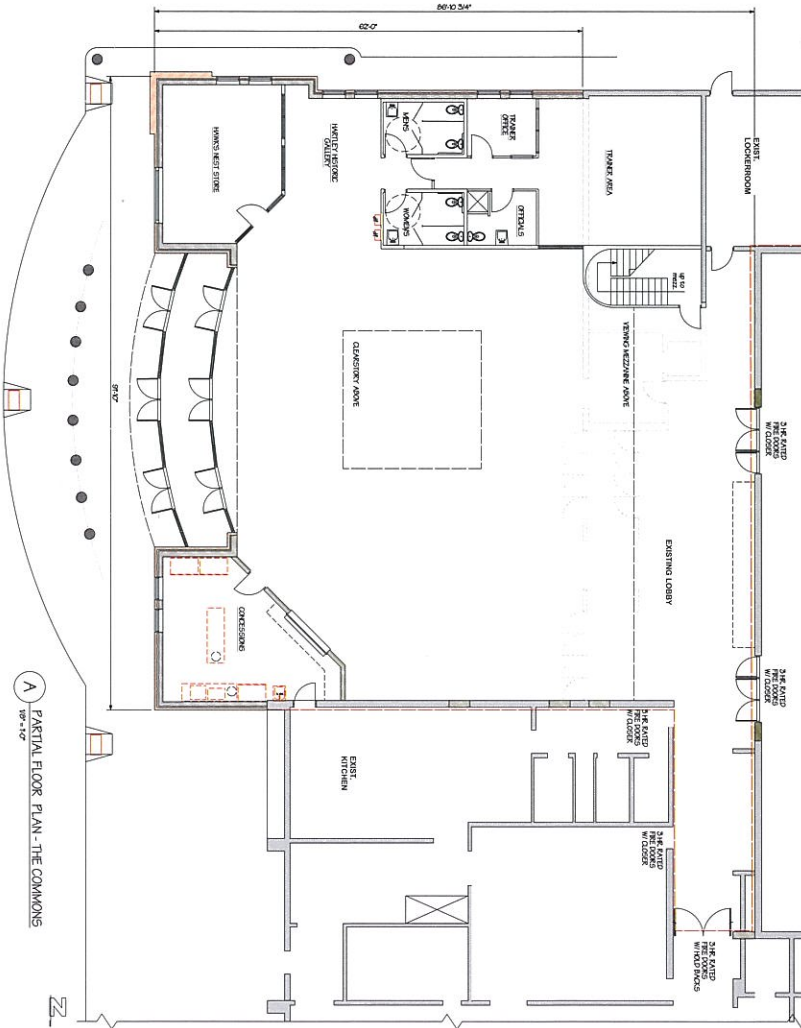

A PARTIAL FLOOR PLAN - THE COMMONS
1/8" = 1'-0"



JOHN A. EBERTS
ARCHITECT
OHIO REG. 10400 AIA
ROAD 1593
COLUMBUS, OHIO 43224

PHONE 614-292-2601
FAX 614-292-2602
jeberts@waynet.net

THE COMMONS LOBBY ADDITION
for
BISHOP HARTLEY HIGH SCHOOL
1285 ZETTLER AVENUE
COLUMBUS, OHIO 43227

DATE 04-17

04-04-17

PRELIM